

CERTIFIED RECORD OF LAND CORNER MONUMENTATION

History of original corner establishment:

None previously established.  
See Record Map of Survey No. 2026

S-6

DIAGRAM

NW  $\frac{1}{16}$  S29

PLS 2645  
2014

Description of corner evidence found:

Not Applicable

Description of monument and accessories I established to perpetuate the original location of this corner:

Set a 3" x 30" aluminum pipe with a 3 1/4" aluminum cap marked as shown in a 1 1/2' diameter mound of stone. A magnet in a clear plastic case was deposited at the base of pipe. Cap is 2 1/2" above the mound of stone.

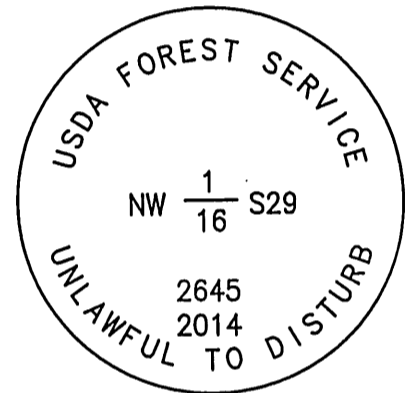

New accessories:

A 12" Tamarack scribed "1/16 S29 BT" with a aluminum tag marked "2645" bears N6°W, 16.1'.  
A 18" Tamarack scribed "1/16 S29 BT" with a aluminum tag marked "2645" bears N57°E, 47.8'.

Geodetic Coordinates (NAD83):

N 44°50'56.5"  
W 119°38'48.5"

Geodetic coordinates were obtained from a Garmin recreational grade GPS receiver.

Date: August 26, 2014

Declination: 17° E

Witnesses: Paul Guglielmelli, Daniel Lee and Torribio Quinones

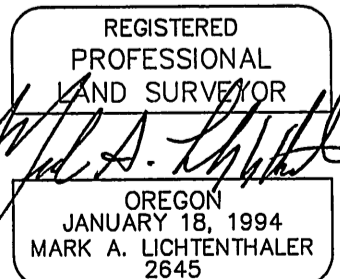

EXPIRES 12-31-2018